

# CLIFFORD®

## Matrix 1 Installation Guide



The Bitwriter® (p/n 998T)  
requires chip version 2.2 or  
newer to program this unit.

Bitwriter®, Code Hopping®, Directed®, Doubleguard®, ESP®, FailSafe®, Ghost Switch®, Learn Routine™, Nite-Lite®, Nuisance Prevention® Circuitry, Revenger®, NPC®, Silent Mode™, Soft Chirp®, Stinger®, Valet®, VRS®, and Warn Away® are all Trademarks or Registered Trademarks of Directed Electronics, Vista, California.

# Table of Contents

What Is Included .....	4
Primary Harness (H1) Wire Connection Guide.....	4
Primary Harness Wiring Diagram .....	4
Primary Harness Wiring Instructions .....	4
Door Lock Harness (H2), 3-PIN Connector .....	10
Peripheral Plug-In Harnesses.....	10
Super Bright LED, 2-Pin WHITE Plug.....	10
Valet/Program Switch, 2-Pin BLUE Plug.....	11
Programmer Interface, 3-Pin BLACK Plug .....	11
Mounting the Receiver/Antenna .....	12
On-Board Dual-Stage Shock Sensor .....	13
Optional Sensor Port, 4-pin Connector .....	13
Programming Jumper .....	14
Light Flash Jumper.....	14
Bypassing Sensor Inputs.....	14
System Features Learn Routine .....	15
System Features Menus .....	18
Menu #1 - Basic Features.....	18
Menu #2 - Advanced Features.....	18
Feature Descriptions .....	19
Menu #1 - Basic Features.....	19
Transmitter/Receiver Learn Routine .....	22
Transmitter Configurations.....	24
3-Button Transmitter Configuration .....	24
4-Button Transmitter Configuration .....	25
Optional Radar Master Transmitter .....	25
Diagnostics .....	25
Arm/Disarm Diagnostics.....	25
System Status Chirps.....	26
Table of Zones .....	26
Long Term Event History.....	26
Multi-Level Security Arming.....	27
Optional Vehicle Recovery System (VRS).....	28
False Alarm Control Technology (FACT).....	28
Smart Power Up II.....	28
Wiring Quick Reference Guide.....	30

# What Is Included

- ▶ One control module with on-board shock sensor
- ▶ One HF+ receiver/antenna with harness
- ▶ Two three-button remote transmitters
- ▶ One 514C siren
- ▶ One 12-pin primary harness with starter kill
- ▶ One plug-in Valet/Program switch
- ▶ One plug-in LED indicator with bezel
- ▶ One 3-pin door lock harness
- ▶ Two window decals
- ▶ One patent card
- ▶ One warranty registration
- ▶ One installation guide
- ▶ One owner's guide

## Primary Harness (H1) Wire Connection Guide

### Primary Harness Wiring Diagram

<b>H1/1</b>	<b>ORANGE</b>	<b>(-) 500 mA Armed Output</b>
<b>H1/2</b>	<b>WHITE</b>	<b>(+)/(-) Selectable Light Flash Output</b>
<b>H1/3</b>	<b>WHITE/BLUE</b>	<b>(-) 200 mA Channel 3 Programmable Output</b>
<b>H1/4</b>	<b>BLACK/WHITE</b>	<b>(-) 200 mA Domelight Supervision Output</b>
<b>H1/5</b>	<b>GREEN</b>	<b>(-) Door Trigger Input, Zone 3</b>
<b>H1/6</b>	<b>BLUE</b>	<b>(-) Instant Trigger Input, Zone 1</b>
<b>H1/7</b>	<b>VIOLET</b>	<b>(+) Door Trigger Input, Zone 3</b>
<b>H1/8</b>	<b>BLACK</b>	<b>(-) Chassis Ground Input</b>
<b>H1/9</b>	<b>YELLOW</b>	<b>(+) Switched Ignition Input, Zone 5</b>
<b>H1/10</b>	<b>BROWN</b>	<b>(+) Siren Output</b>
<b>H1/11</b>	<b>RED</b>	<b>(+) Constant Power Input</b>
<b>H1/12</b>	<b>RED/WHITE</b>	<b>(-) 200 mA Channel 2 Output</b>

### Primary Harness Wiring Instructions

This guide describes in detail the connection of each wire. Also included are possible applications of each wire. This system was designed with the ultimate in flexibility and security in mind. Many of the wires have more than one possible function. Please read carefully to ensure a thorough understanding of this unit.

### H1/1 ORANGE (-) ground-when-armed output

This wire supplies a (-) ground as long as the system is armed. This output ceases as soon as the system is disarmed. The orange wire is pre-wired to control the 8618 starter kill relay. It can supply up to 500 mA of current.

NOTE: If using the H1/1 ORANGE wire to activate an add-on accessory such as window automation, pager or voice module a 1Amp diode must be installed to ensure proper operation. Insert the diode as shown in the following diagram.

**IMPORTANT!** Never interrupt any wire other than the starter wire.

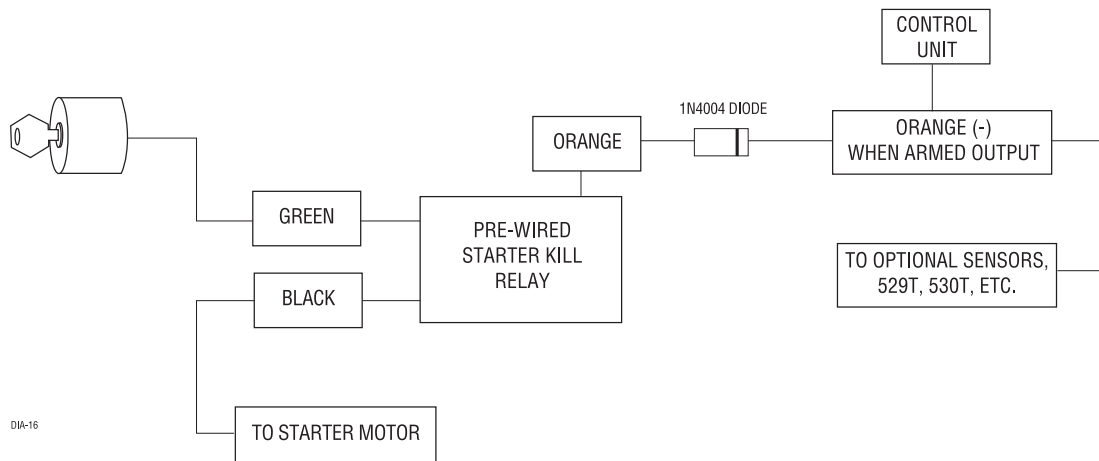

### H1/2 WHITE (+/-) light flash output

As shipped, the H1/2 WHITE wire should be connected to the (+) parking light wire. If the light flash polarity jumper is moved to the (-) position (see the *Programming Jumper* section of this installation guide), this wire supplies a (-) 200 mA output. This is suitable for driving (-) light control wires in Toyota, Lexus, BMW, some Mitsubishi, some Mazda, and other models.

NOTE: For parking light systems that draw 10 amps or more, the jumper must be switched to a (-) light flash output (see the *Programming Jumpers* section of this guide). P/N 8617 or a standard automotive SPDT relay must be used on the H1/2 light flash output wire.

**IMPORTANT! DO NOT** connect this wire to a negative vehicle light flash wire before changing the programming jumper to the negative polarity position or damage to vehicle light circuit may occur.

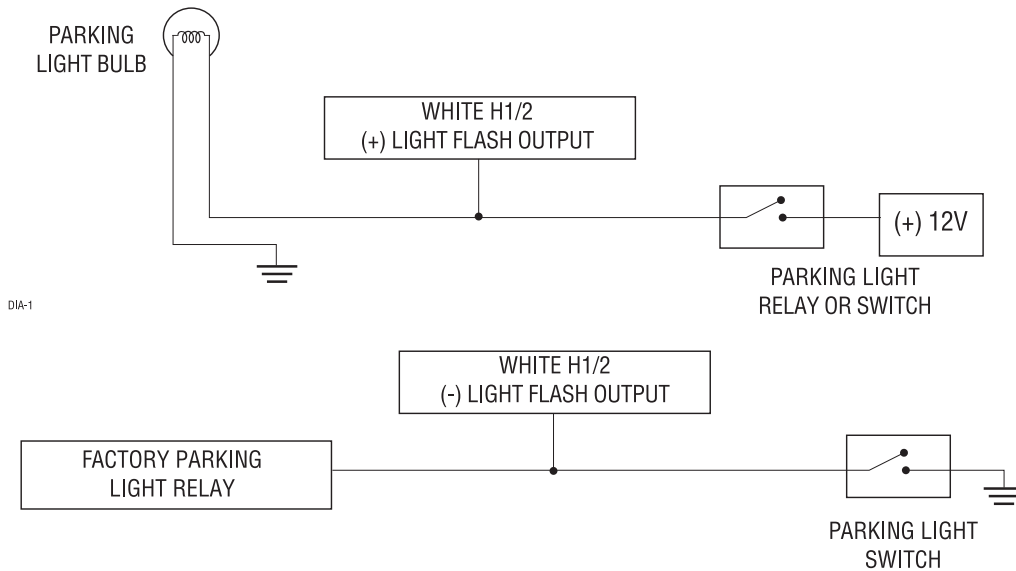

### *H1/3 WHITE/BLUE 200 mA (-) channel 3 output*

This wire provides a (-) 200 mA output whenever the transmitter button(s) controlling channel three is pressed. This output can be programmed to provide the following types of output (see *System Features Learn Routine* section of this guide):

- ▶ A **validity** output will send a signal as long as the transmission is received.
- ▶ A **latched** output will send a signal continuously when the channel three button(s) is pressed and released. The signal will continue until channel three is pressed again.
- ▶ A **latched/reset with ignition** output works similar to the latched output, but will also reset (output will stop) when the ignition is turned on and then off.
- ▶ A **30 second timed** output will send a signal for 30 seconds when channel three is pressed. This output can be shut off during the 30-second period by pressing Channel 3 again.
- ▶ This output can also be programmed to provide a **second unlock pulse** when the unlock button is pressed a second time after disarming the system. This can be used to unlock the passenger doors when installing progressive door locks.

**IMPORTANT!** Never use this wire to drive anything but a relay or a low-current input! This transistorized output can only supply 200 mA, and connecting directly to a solenoid, motor, or other high-current device will cause the module to fail.

### H1/4 BLACK/WHITE (-) 200 mA domelight supervision output

Connect the H1/4 wire to the optional domelight supervision relay as shown in the following diagram:

**IMPORTANT!** This output is only intended to drive a relay. It cannot be connected directly to the domelight circuit, as the output cannot support the current draw of one or more bulbs.

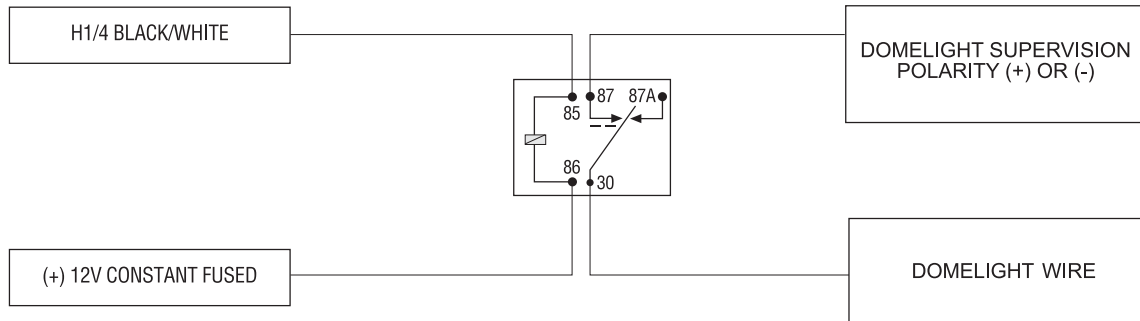

### H1/5 GREEN (-) door trigger input

Most vehicles use negative door trigger circuits. Connect the green wire to a wire showing ground when any door is opened. When connecting to newer model vehicles there is generally a need to use individual door triggers. See DirectFax document 1076 for wiring instructions. This wire will report Zone 3.

NOTE: If using a door trigger wire that has a delay, Advanced Menu 2, feature 6 or the 998T Bitwriter can be used to turn Bypass Notification off.

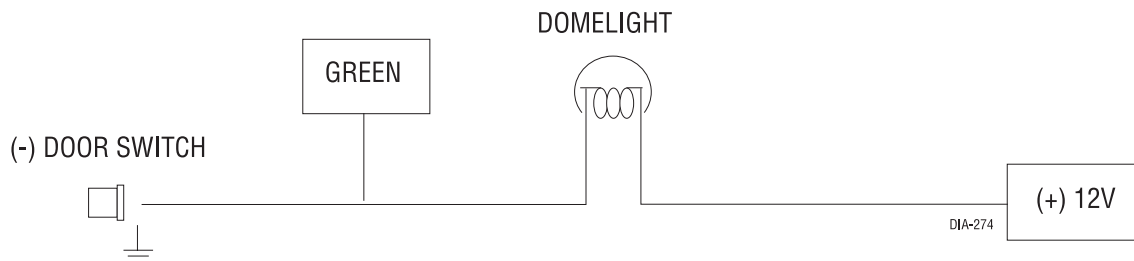

### H1/6 BLUE (-) instant trigger input

This input will respond to a negative input with an instant trigger. It is ideal for hood and trunk pins and will report on Zone 1. It can also be used with Directed single-stage sensors. The H1/6 blue instant trigger wire can also be used to shunt sensors during operation of auxiliary channels or remote start. (See *Bypassing Sensor Inputs* section of this guide.)

### *H1/7 VIOLET (+) door trigger input*

This type of dome circuit is used in many Ford products. Connect the violet wire to a wire that shows (+)12V when any door is opened. This wire will report Zone 3.

NOTE: If using a door trigger wire that has a delay, Advanced Menu 2, feature 6 or the 998T Bitwriter can be used to turn Bypass Notification off.

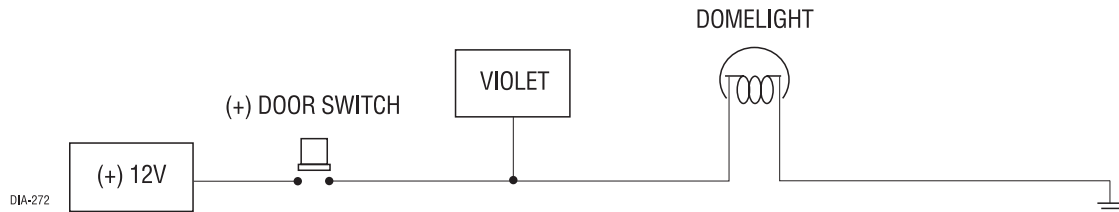

### *H1/8 BLACK (-) chassis ground connection*

Connect this wire to a clean, paint-free sheet metal location (driver kick panel) using a factory bolt that DOES NOT have any vehicle component grounds attached to it. A screw should only be used when in conjunction with a two-sided lock washer. Under dash brackets and door sheet metal are not acceptable ground points. It is recommended that all security components be grounded at the same location.

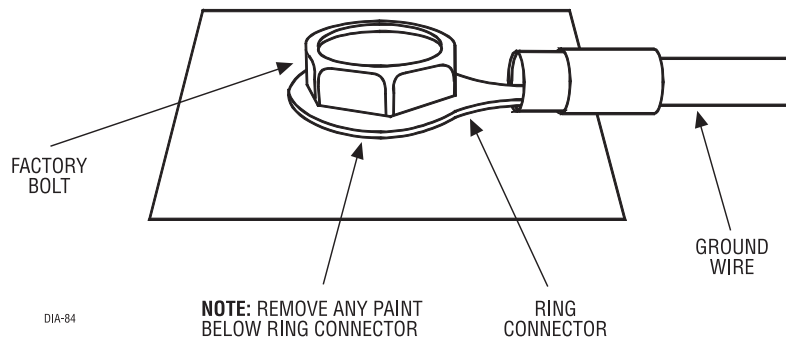

### *H1/9 YELLOW (+) ignition input*

Connect this wire to the (+) 12 volts ignition wire. This wire is pre-wired to the starter kill relay and must show (+) 12 volts with the key in RUN position and during cranking. Take great care that this wire cannot be shorted to the chassis at any point.



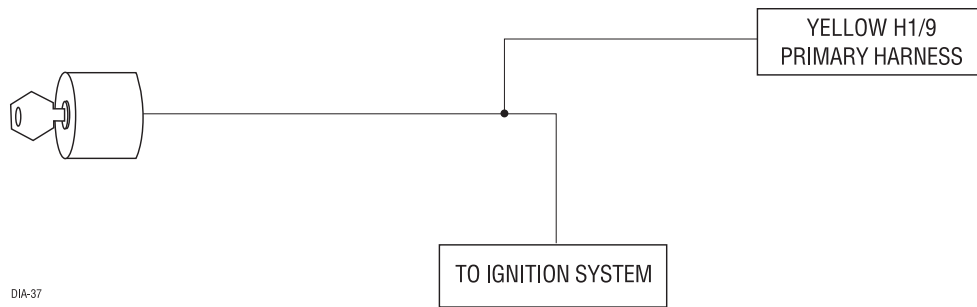

DIA-37

### *H1/10 BROWN (+) siren output*

Connect this to the RED wire of the Revenger® siren. Connect the BLACK wire of the siren to (-) chassis ground, preferably at the same point you connect the control module's BLACK ground wire.

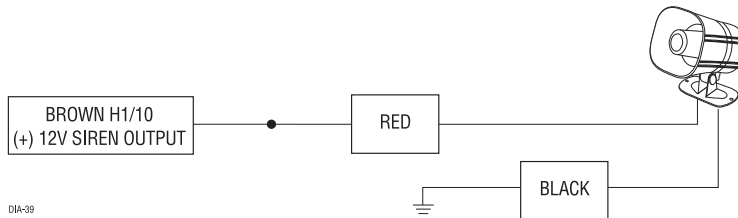

DIA-39

### *H1/11 RED (+)12V constant power input*

Before connecting this wire, remove the supplied fuse. Connect to the battery positive terminal or the constant 12V supply to the ignition switch.

NOTE: Always use a fuse within 12 inches of the point you obtain (+)12V. Do not use the 15 amp fuse in the harness for this purpose. This fuse protects the module itself.

### *H1/12 RED/WHITE 200 mA (-) channel 2 output*

When the system receives the code controlling channel 2 for longer than 1.5 seconds, the RED/WHITE will supply an output as long as the transmission continues. This is often used to operate a trunk/hatch release or other relay/driven function.

**IMPORTANT!** Never use this wire to drive anything but a relay or a low-current input! The transistorized output can only supply 200 mA of current. Connecting directly to a solenoid, motor, or other high-current device will cause it to fail.

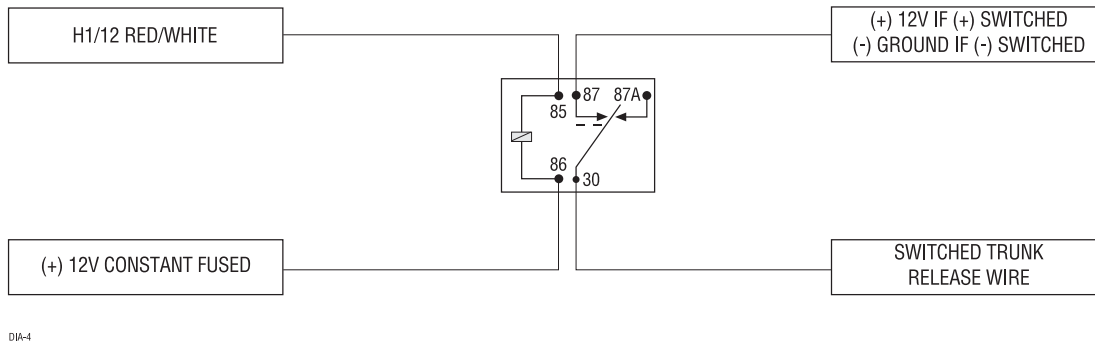

## Door Lock Harness (H2), 3-PIN Connector

<b>H2/A</b>	<b>Green</b>	<b>(-) Lock, (+) Unlock Output</b>
<b>H2/B</b>	<b>Empty</b>	<b>Unless Using 451M</b>
<b>H2/C</b>	<b>Blue</b>	<b>(-) Unlock, (+) Lock Output</b>

**IMPORTANT!** The door lock outputs are low current and should not be attached directly to any high current device; they are only to be used to activate relays

NOTE: For detailed instructions about connecting to the vehicle's power door lock systems, refer to the Door Lock Wiring guide (Document No. 1041) available to authorized dealers only from the technical resources listed at the front of this guide.

## Peripheral Plug-In Harnesses

### Super Bright LED, 2-Pin WHITE Plug

The super bright LED operates at (+) 2 volt DC and plugs into the two-pin WHITE port. Make sure the LED wires are not shorted to ground as the LED will be damaged. Multiple LED's can be used, but they must be wired in series. The LED fits into a 9/32-inch mounting hole. Be sure to check for clearance prior to drilling the mounting hole.

NOTE: Never use a BLUE LED in combination with a RED LED.

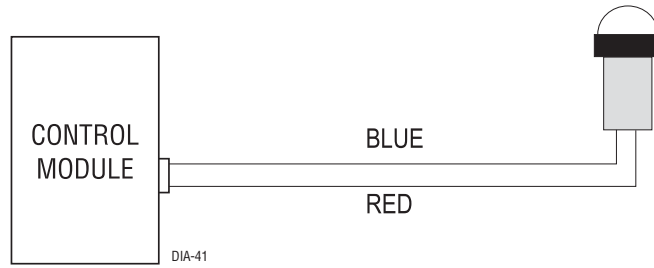

### Valet/Program Switch, 2-Pin BLUE Plug

The Valet/Program button should be accessible from the driver's seat. It plugs into the BLUE port on the side of the unit. Since the system features Valet® by using the remote transmitter, the button can be well hidden. Consider how the button will be used before choosing a mounting location. Check for rear clearance before drilling a 9/32-inch hole and mounting the button. The GRAY wire in the two-pin plug may also be used as a (+) ghost switch input and can be connected to any (+) switch in the vehicle. (See *Feature Descriptions* section of this guide.)

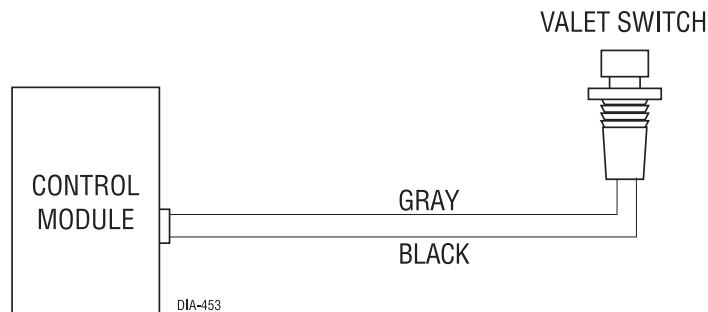

### Programmer Interface, 3-Pin BLACK Plug



The BLACK three-pin port is provided for programming of the unit. When using the 998T Bitwriter, it is possible to configure any and all of the programmable functions. For more information please refer to the guide packaged with the programmer.

## Mounting the Receiver/Antenna

Receiver/antenna position should be discussed with the vehicle owner prior to installation, since the antenna may be visible to the vehicle's operator.

The best location for the receiver/antenna is centered high on either the front or rear windshield. For optimal range, the antenna should be mounted vertically. It can be mounted horizontally in relation to the windshield or under the dashboard away from metal, but range will be diminished. Metallic window tint can also affect range, so this should be a consideration when determining the mounting location.

After determining the best mounting location, follow these steps:

1. Clean the mounting area with a quality glass cleaner or alcohol to remove any dirt or residue.
2. Plug the receiver/antenna cable into the receiver/antenna.
3. Mount the receiver/antenna using the supplied double-sided tape.
4. Route the receiver/antenna cable to the control module and plug it into the four-pin antenna connector.

**IMPORTANT!** To achieve the best possible range, DO NOT leave the antenna cable bundled under the dash. Always extend the cable full length during installation, regardless of the antenna mounting location.

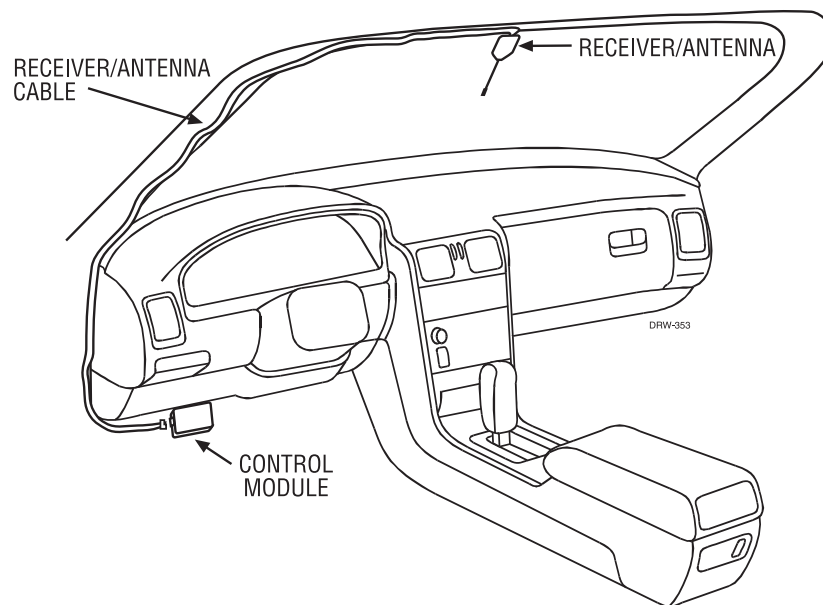

# On-Board Dual-Stage Shock Sensor

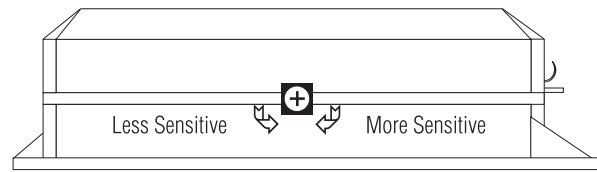

DRW-52

There is a dual-stage shock sensor inside the control unit. Adjustments are made via the rotary control as indicated in the diagram. Since the shock sensor does not work well when mounted firmly to metal, we do not recommend screwing down the control module. The full trigger of the on-board shock sensor reports *Zone 2*. (See *Table of Zones* section of this guide.)

Note: When adjusting the sensor, it must be in the same mounting location that it will be after the installation is completed. Adjusting the sensor and then relocating the module requires readjustment.

## Optional Sensor Port, 4-pin Connector

This port is provided so that additional sensor can be added to the system. Optional sensors include the required harness to connect to this port.

*RED (+) 12V Constant and BLACK (-) Ground*

These wires supply constant (+) 12 volts and ground to the optional sensor.

*BLUE/ORANGE (-) Multiplex Input*

These wires are multiplex inputs. If a (-) input of less than 0.8 seconds is supplied to either wire, the Warn-Away response will occur. A (-) input of longer than 0.8 seconds to either wire will initiate the triggered sequence and report *Zone 4*.

# Programming Jumper

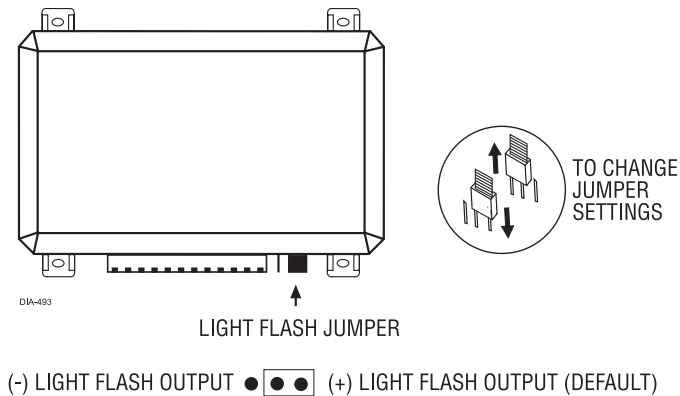

## Light Flash Jumper

This jumper is used to determine the light flash output. In the (+) position, the on-board relay is enabled and the unit will output (+)12V on the WHITE wire, H1/2. In the (-) position, the on-board relay is disabled. The WHITE wire, H1/2, will supply a 200 mA (-) output suitable for driving factory parking light relays.

NOTE: For parking light circuits that draw 10 amps or more, the jumper must be switched to a (-) light flash output. P/N 8617 or a standard automotive SPDT relay must be used on the H1/2 light flash output harness wire.

**IMPORTANT!** DO NOT connect the H1/2 light flash wire to a negative vehicle light flash wire before changing the programming jumper to the negative polarity position or damage to vehicle light circuit may occur.

## Bypassing Sensor Inputs

There are times when you need to temporarily bypass all sensor inputs to the unit, such as when remote starting the vehicle. Anytime an auxiliary channel output is used, all inputs are bypassed for 5 seconds. During the 5 second bypass period, ground can be supplied to the H1/6 Blue wire without triggering the unit. When the 5 second bypass period ends, if the unit sees ground on the

H1/6 Blue wire, all trigger inputs except the door trigger input will remain bypassed until 5 seconds after ground is removed from the BLUE wire. This can be done using the status output of a Directed Electronics remote engine starting unit as shown in the following diagram:

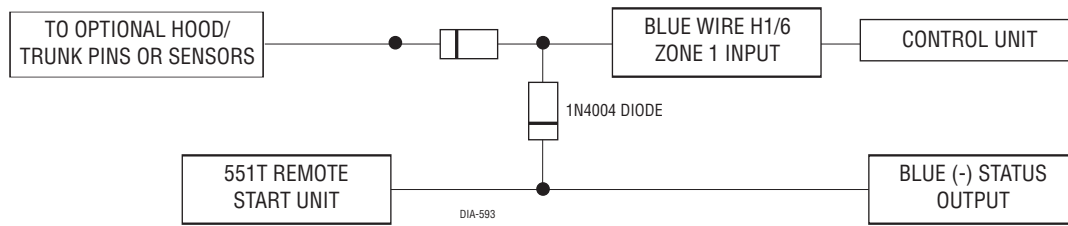

## System Features Learn Routine

The System Features Learn Routine dictates how the unit operates. Due to the number of steps, they have been broken up into two menus. It is possible to access and change any of the feature settings using the Valet/Program switch. However, this process can be greatly simplified by using the 998T Bitwriter. Any of the settings can be changed and then assigned to a particular transmitter, up to four, a feature called Owner Recognition. Each time that particular transmitter is used to disarm the system, the assigned feature settings will be recalled. Owner Recognition is only possible when programming the unit via the 998T Bitwriter.

If the system was previously programmed using the 998T Bitwriter, the learn routine may be locked. If the siren generates one long chirp when attempting to program the unit, the learn routine is locked and must be unlocked using the 998T Bitwriter.

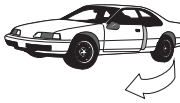

1. **Open a door.** (The H1/5 GREEN wire or the H1/7 VIOLET wire must be connected.)



2. **Ignition.** Turn the ignition on, then back off: (The H1/9 YELLOW wire must be connected.)



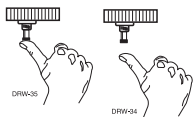

3. **Select a Menu.** Press and HOLD the Valet/Program switch: (The Valet/Program switch must be plugged into the blue port.) After three seconds the siren will chirp once indicating entry to the Basic Features Menu #1. If this is the menu you wish to access, release the button and go on to Step 4. If the button is not released, you will jump to the Advanced Features Menu #2 and the siren will chirp twice. Once you have selected the desired menu, release the Valet/Program button and then proceed to Step 4.



4. **Select a Feature.** Press and release the Valet/Program switch the number of times corresponding to the feature you wish to change. For example, to access the third feature, press and release the switch three times. Then press the switch once more and HOLD it. The siren will chirp the number of times equal to the step you have accessed.



5. **Program the Feature.** While HOLDING the Valet/Program switch, you can toggle the feature on and off using the remote transmitter. Pressing  will select the one chirp setting. Pressing  will select the two chirp setting. (See *System Features Menus* section of this guide.)

NOTE: Press  to choose the non-default settings for features with more than two options.



6. **Release the Valet/Program Switch.**

*Once a feature is programmed:*

- ▶ Other features can be programmed within the same menu.
- ▶ Another menu can be selected.
- ▶ The learn routine can be exited if programming is complete.



*To access another feature in the same menu:*

1. Press and release the Valet/Program switch the number of times necessary to advance from the feature you just programmed to the next one you want to program.
2. Then press the Valet/Program switch once more and HOLD it.

For example, if you just programmed the third feature in the menu and you would like to program the seventh feature in the menu, you would press and release the Valet/Program switch four times and then press it once more and HOLD it. The siren would chirp seven times to confirm access to the seventh feature.

*To select another menu:*

1. Press and HOLD the Valet/Program switch.
2. After three seconds, the unit will advance to the next menu and the siren will chirp, indicating which menu has been accessed.

For instance, if you just programmed some features in Menu #1 (Basic Features) and you wish to program a feature in Menu #2, you press and HOLD the Valet/Program button. After three seconds, the siren chirps twice indicating access to Menu #2.

*To exit the learn routine do one of the following:*

- Close the open door.
- Turn the ignition on.
- No activity for longer than 15 seconds.
- Press the Valet/Program switch too many times.

# System Features Menus

## Menu #1 - Basic Features

Items in bold text have been programmed to the default setting at the factory.

Feature Number	One Chirp Setting	Two-Chirp Setting
1-1	<b>Active arming</b>	Passive arming
1-2	<b>Chirps ON</b>	Chirps OFF
1-3	<b>Ignition controlled door locks ON</b>	Ignition controlled door locks OFF
1-4	<b>Active locking only</b>	Passive locking
1-5	<b>Panic with ignition on</b>	No Panic with ignition on
1-6	<b>0.8 second door lock pulses</b>	3.5 second door lock pulses/0.4 sec.
1-7	<b>Forced passive arming ON</b>	Forced passive arming OFF
1-8	Automatic Engine Disable ON	<b>Automatic Engine Disable OFF</b>
1-9	<b>Armed When Driving (AWD)</b>	Vehicle Recovery System (VRS)
1-10	<b>Anti Code Grabbing ON</b>	Anti Code Grabbing OFF

## Menu #2 - Advanced Features

Feature Number	One Chirp Setting	Two-Chirp Setting
2-1	<b>Siren</b>	Horn honk
2-2	<b>30-second siren duration</b>	60-second siren duration*
2-3	<b>FACT ON</b>	FACT OFF
2-4	<b>Progressive door trigger</b>	Instant door trigger
2-5	<b>Valet switch input: 1 pulse</b>	Valet switch input: 2-5 pulses
2-6	<b>Door Trigger Error Notification ON</b>	Door Trigger Error Notification OFF
2-7	<b>Ignition-controlled domelight ON</b>	Ignition-controlled domelight OFF
2-8	<b>Single unlock pulse</b>	Double unlock pulse
2-9	<b>Single lock pulse</b>	Double lock pulse
2-10	<b>Channel 3: Validity</b>	Channel 3: latched/latched, reset with ignition/30-second timed/second unlock output
2-11	Comfort Closure (On) (20 sec.)	<b>Comfort Closure (Off)</b>

# Feature Descriptions

The features of the system are described below. Features that have additional settings that can be selected only when programming with the 998T Bitwriter are indicated by the following icon:



## Menu #1 - Basic Features

*1-1 ACTIVE/PASSIVE ARMING:* When active arming is selected, the system will only arm when the transmitter is used. When set to passive, the system will arm automatically 30 seconds after the last door is closed. To alert the consumer of passive arming, the siren will chirp 20 seconds after the door is closed. This provides the consumer with an audible prior to the system actually arming. At the 30 second mark, the system will arm but the siren will not chirp.

*1-2 CHIRPS ON/OFF:* This feature controls the chirps that confirm the arming and disarming of the system.



*1-3 IGNITION CONTROLLED DOOR LOCKS ON/OFF:* When turned on, the doors will lock three seconds after the ignition is turned on and unlock when the ignition is turned off. The 998T Bitwriter will display separate steps for ignition lock and ignition unlock. They can be programmed on or off independently.

*1-4 ACTIVE/PASSIVE LOCKING:* If passive arming is selected in step 1-1, then the system can be programmed to either lock the doors when passive arming occurs, or only lock the doors when the system is armed via the transmitter. Active locking means the system will not lock the doors when it passively arms. Passive locking means that the system will lock the doors when it passively arms.

**NOTE:** Remember, when passive arming is selected, the unit will chirp 20 seconds after the last door is closed. The system does not actually arm or lock the doors until 30 seconds after the door has been closed.

*1-5 PANIC WITH IGNITION ON:* This step controls whether or not the Panic Mode is available with the ignition on. In some states, there are laws prohibiting a siren from sounding in a moving vehicle. This feature makes the system compliant with these regulations.

*1-6 DOOR LOCK PULSE DURATION:* Some European vehicles, such as Mercedes-Benz and Audi, require longer lock and unlock pulses to operate the vacuum pump. Programming the system to provide 3.5 second pulses, will accommodate the door lock interface in these vehicles. The default

setting is 0.8 second door lock pulses. For some vehicles a 0.4 second pulse duration is required to prevent the windows from moving.

*1-7 FORCED PASSIVE ARMING ON/OFF:* To use this feature, passive arming must be selected in step 1-1. When turned on, forced passive arming will ensure that the system will passively arm, even if a zone is left open or invalid. Forced passive arming occurs one hour after the ignition is turned off.

*1-8 AUTOMATIC ENGINE DISABLE (AED) ON/OFF:* AED is a full-time, passive starter disable that works independently of the security system. When turned on, the orange, ground-when-armed output (H1/1) will go active 30 seconds after the ignition is turned off. The LED will flash at half its normal rate when the ignition is turned off to indicate that AED is active and will interrupt the starter in 30 seconds. AED does not occur in Valet mode and can be bypassed using the emergency override procedure. The transmitter can also be used to disarm AED.

*1-9 ARMED WHILE DRIVING/VEHICLE RECOVERY SYSTEM:* In the default setting (Armed While Driving), the system can be armed with the ignition on. When armed, the ground-when-armed is not active and the sensors are bypassed. The door triggers will remain active. If programmed to the Vehicle Recovery System (VRS®) setting, VRS® will be activated.

*1-10 ANTI-CODE GRABBING ON/OFF:* The system uses a mathematical formula to change its code each time the transmitter and receiver communicate. This makes the group of bits or “word” from the transmitter very long. The longer the word is, the easier it is to block its transmission to the unit. Disabling this feature lets the receiver ignore the Anti-Code Grabbing part of the transmitted word. As a result, the unit may have better range with the Anti-Code Grabbing feature off.

## **Menu #2 - Advanced Features**

*2-1 SIREN/HORN HONK:* The system can be programmed to output pulses instead of a continuous output when the system is triggered. This is useful to honk the factory horn in applications where a siren is undesirable. Remember that the unit is only capable of supplying 1 amp of current. A relay will be required to interface with most factory horn systems.



*2-2 SIREN DURATION 30/60 SECONDS:* It is possible to program the unit to sound for 30 or 60 seconds during the triggered sequence. Some states have laws regulating how long a security system can sound. When using the 998T Bitwriter, the siren can be programmed to sound for any length of time ranging from 1 to 180 seconds. Using the SELECT button of the 998T Bitwriter will adjust the siren duration in one second increments.

*2-3 FALSE ALARM CONTROL TECHNOLOGY (FACT) ON/OFF:* FACT stops repeated triggering of the same zone. If one zone is triggered three times in one hour, that zone is bypassed for one hour, starting from the time of the third trigger. During that hour, if the system detects a trigger on that zone again, the system resets the one hour timer. If one hour passes and the zone has not triggered again, the zone is activated and can trigger the system again. FACT monitors sensor inputs and door triggers, but does not bypass the ignition trigger at any time. If FACT is turned off, the system will respond to repeated triggers on the sensor inputs and will do so indefinitely. Some states have laws regulating how many times a security system can trigger before it is considered a nuisance and the vehicle is towed away.

*2-4 PROGRESSIVE DOOR TRIGGER ON/OFF:* The system responds to a door trigger input with a progressive response. When the door is opened with the system armed, the siren will chirp 10 times prior to the full triggered sequence. The door trigger is still treated as an instant trigger and closing the door quickly will not prevent a full triggered sequence from occurring. If the progressive door trigger is programmed off, the full siren output will occur the moment the door is opened.

*2-5 VALET PULSE COUNT ONE TO FIVE PULSES:* The system can be programmed to count the number presses of the valet button before disarming the security system or VRS®. The factory default setting is one pulse. The unit can be set for two to five pulses using the two-chirp setting to select the pulse count.

Ghost Switch Option: For added security, the GRAY wire on the two-pin Valet/Program can be connected to any switch in the vehicle that provides a positive (+) momentary pulse.

*2-6 DOOR TRIGGER ERROR CHIRP ON/OFF:* With the door trigger error chirp programmed off, the system will not report an invalid zone on arming when the door trigger wire is active. This eliminates the extra chirps that occur when interfacing with vehicles that have exceptionally long dome light delay circuits.

*2-7 IGNITION-CONTROLLED DOMELIGHT SUPERVISION ON/OFF:* If turned on, the system will turn on the domelight for 30 seconds when the ignition is turned off. The optional domelight supervision feature must be installed.

*2-8 DOUBLE PULSE UNLOCK ON/OFF:* Some vehicles require two pulses on a single wire to unlock the doors. When the double pulse unlock feature is turned on, the BLUE H2/C wire will supply two negative pulses instead of a single pulse. At the same time, the GREEN H2/A wire will supply two positive pulses instead of a single pulse. This makes it possible to directly interface with double pulse vehicles without any extra parts.

*2-9 DOUBLE/SINGLE PULSE LOCK:* Some vehicles require two pulses on a single wire to unlock the doors. When the double pulse unlock feature is turned on, the GREEN H2/A wire will supply two negative pulses instead of a single pulse. At the same time, the BLUE H2/C wire will supply two positive pulses instead of a single pulse. This makes it possible to directly interface with double pulse vehicles without any extra parts.

*2-10 CHANNEL 3 VALIDITY/LATCHED/LATCHED RESET WITH IGNITION/30 SECOND TIMED/SECOND UNLOCK OUTPUT:* Channel 3 can be programmed for these output configurations. The unit is set to the default validity output.

*2-11 COMFORT CLOSURE:* The system can be programmed to close the windows when the system is armed. A 20-second output starts 200mS after the last lock pulse. The Comfort Closure output will be canceled if the system is disarmed while it is still active. If programmed, the lock output wire will provide this function.

## Transmitter/Receiver Learn Routine

The system comes with two transmitters that have been taught to it. The system can store up to four different transmitter codes in memory. Use the following learn routine to add transmitters to the system or to change button assignments if desired.

If the system was previously programmed using the 998T Bitwriter, the learn routine may be locked. If the siren generates one long chirp when attempting to program the unit, the learn routine is locked and must be unlocked using the 998T Bitwriter before proceeding.



1. **Open a door.** (The GREEN wire, H1/5, or the VIOLET, H1/7 must be connected.)



2. **Turn the ignition on.** (The YELLOW wire, H1/9 must be connected.)



3. **Select the receiver channel:** Press and release the Valet/Program button the number of times necessary to access the desired channel.

NOTE: If adding a remote, a button must be taught to the unit in the Channel 1 or Channel 5 position prior to programming other channels.

Press and hold the Valet/Program button once more. The siren will chirp and the LED will blink the number of times corresponding to the channel that is accessed.

Channel Number	Function	Wire Color
1	Arm/Disarm/Panic	
2	Silent Mode/Remote Valet/Trunk Release	RED/WHITE
3	Remote Start or other accessories	WHITE/BLUE
4	Arm only (only available with Radar Master remote) <sup>1</sup>	
5	Disarm only (only available with Radar Master remote) <sup>1</sup>	
6	Panic only (only available with Radar Master remote) <sup>1</sup>	
7	Auto-learn 3-Button Transmitter Configuration <sup>2</sup>	
8	Auto-learn 4-Button Transmitter Configuration <sup>2</sup>	
9	Zap (delete all transmitters) <sup>3</sup>	

<sup>1</sup>NOTE: Channels 4-6 are only available when using an optional Radar Master remote.  
<sup>2</sup>NOTE: For Auto Learn Configurations, see *Transmitter Configurations* section of this guide.  
<sup>3</sup>NOTE: See Channel 9 description in this section.

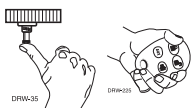

4. **Press the transmitter button:** While HOLDING the Valet/Program switch, press the button from the transmitter that you wish to assign to the selected channel. The unit will chirp once indicating that the channel has been entered.



5. **Press the same transmitter button again:** While still HOLDING the Valet/Program switch, press the same transmitter button that you just programmed. The siren will chirp twice to confirm that the desired channel has been successfully programmed to the transmitter button. If this step is not performed, the channel will not be programmed to the transmitter button. It is not possible to teach a transmitter button to the system more than once.



6. **Release:** Once the code is learned, the Valet/Program button can be released.

**Channels 4-6** (available only when using a Radar Master remote)

Channels 4 through 6 are used to assign the arm, disarm and panic functions to separate buttons on the remote control. These channels are only available when using an optional Radar Master remote. (See *Transmitter Configurations* section of this guide.) Teaching a transmitter button to Channel 4 erases all previous programming from the transmitter's memory. Similarly, if the transmitter is set up to use the separate arm, disarm and panic channels and a button from that transmitter is programmed to Channel 1, the transmitter's memory will be erased, and the system will only recognize the button that was programmed to Channel 1.

**Channel #9:** If any button from a known transmitter is programmed to Channel 9, all transmitters will be erased from memory and the system features will revert to the default settings. This is useful in cases where the one of the customer's transmitters is lost or stolen. This will erase any lost or stolen transmitters from the system's memory. It can also be used to start from scratch if the transmitter buttons were programmed incorrectly.



5. **Release.** Once the code is learned, the Valet/Program button can be released.

*To exit the learn routine:*

One long chirp indicates that Learn Routine has been exited. Learn Routine will be exited if any of the following occurs:

- ▶ Ignition is turned off.
- ▶ Door is closed.
- ▶ Valet/Program button is pressed too many times.
- ▶ More than 15 seconds elapse between steps.



## Transmitter Configurations

Using the Auto Learn functions in the Transmitter/Receiver Learn Routine, the transmitters can be programmed either with the 3-button (standard) configuration or 4-button configuration, which requires an optional 4-button transmitter.

### 3-Button Transmitter Configuration





This configuration can be programmed to a 3-button transmitter using Channel 7 of the Transmitter/Receiver Learn Routine. The transmitter buttons are assigned to the following functions:



-  .....operates .....Arm/Disarm/Panic
-  .....operates .....Channel 2
-  .....operates .....Channel 3

### 4-Button Transmitter Configuration

This system has a 4-button transmitter configuration that can be used when upgrading to an optional 4-button remote. This configuration can be programmed to a 4-button transmitter using Channel 8 of the Transmitter/Receiver Learn Routine. In the 4-button transmitter configuration, the buttons are assigned to the following functions:

-  .....operates .....Arm/Disarm/Panic
-  .....operates .....Channel 2
-  .....operates .....Channel 3
-  .....is .....Unassigned

### Optional Radar Master Transmitter

Separate transmitter button arming/disarming/panic (Channels 4-6, see channel chart in *Transmitter/Receiver Learn Routine* section) can only be utilized when upgrading to an optional Radar Master transmitter. When using a Radar Master transmitter with this system, Channels 4-6 may be programmed to the transmitter in a variety of configurations.

## Diagnostics

The system’s microprocessor monitors and reports all active and violated zones when arming and disarming. LED flashes indicate the active or violated zone; siren chirps indicate system status.

### Arm/Disarm Diagnostics

The number of siren chirps will indicate the status of the alarm when arming and disarming. For information on which zone is active or has been violated refer to the Table of Zones.

## System Status Chirps

Action	Number of Chirps	Description
Arm	1	System armed
Arm	1 (3 second delay), 1	System armed with Bypass Notification
Disarm	2	System disarmed
Disarm	4	System disarmed with Tamper Alert
Disarm	5	System disarmed FACT active

## Table of Zones

Zone No.	Trigger type	Input description
1	Instant	H1/6 BLUE - Connect to optional hood/trunk pins.
2	On-board shock sensor	Heavy impact detected by the on-board shock sensor.
3	Door switch: two-stage or instant	H1/5 GREEN or H1/7 VIOLET door switch
4	Multiplexed Input	BLUE and ORANGE wires of optional sensor plug. Inputs shorter than 0.8 seconds will trigger a Warn Away response, while inputs longer than 0.8 seconds will instantly trigger a full alarm sequence and report Zone 4.
5	Two-stage (similar to doors)	Ignition input. H1/9 YELLOW.

NOTE: The Warn Away® response does not report on the LED.

## Long Term Event History

The system stores the last two full triggers in memory. These are not erasable. Each time the unit sees a full trigger, the older of the two triggers in memory will be replaced by the new trigger. To access long term event history:



1. With the ignition off, press and HOLD the Valet/Program switch.



2. Turn on the ignition.



3. Release the Valet/Program switch.

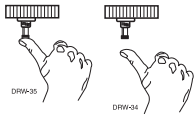

4. Press and release the Valet/Program switch within 5 seconds. The LED will flash in groups indicating the last two zones that triggered the unit. The LED will flash for one minute or until the ignition is turned off.

NOTE: The Warning Zone triggers are not stored to memory and will not be reported.

## Multi-Level Security Arming

Multi-Level Security Arming is only available when using an optional Radar Master transmitter that has been configured with separate transmitter buttons for arming and disarming. Multi-Level Security Arming allows you to select which of the system's inputs or sensors will be active or bypassed at the time that the system is armed. (See *Table of Zones* section.) Pressing the arm button again within five seconds of arming the system will activate Multi-Level Security Arming. Each time the arm button is pressed again, a different security level is selected. The different security levels can be selected as follows:

- ▶ Pressing the arm button once: The siren chirps once. The system is armed.
- ▶ Pressing the arm button twice within five seconds: The siren chirps twice followed by a long chirp. Zone Two is now bypassed.
- ▶ Pressing the arm button a third time within five seconds: The siren chirps three times followed by a long chirp. Zone Four is now bypassed.
- ▶ Pressing the arm button a fourth time within five seconds: The siren chirps four times followed by a long chirp. Zones Two and Four are now bypassed.
- ▶ Pressing the arm button a fifth time within five seconds: The siren chirps five times followed by a long chirp. All input zones, except the ignition, are now bypassed.

NOTE: Multi-Level Security Arming only applies to a single arming cycle. Once the system is disarmed and then re-armed, all the zones will be active again.

# Optional Vehicle Recovery System (VRS)

VRS is an optional feature designed to disable a vehicle during a carjacking event. It must be programmed in the features menu and the Failsafe Starter Kill must be installed for it to work properly. For operational instructions when testing VRS refer to the owner's manual.

## False Alarm Control Technology (FACT)

FACT requires that you change the way you test the system, as FACT will bypass an input zone for 60 minutes. If the system detects the same zone triggering three times AND the triggers are spaced less than an hour apart, the system will bypass that input zone for 60 minutes. If that zone does not attempt to trigger the system during the 60-minute bypass period, the zone's monitoring will begin again at the end of the hour. If it does attempt to trigger while bypassed, the 60-minute bypass starts over again.

Disarming and rearming the system does not reset FACT. The only way to reset FACT is for the 60 minutes to pass, without a trigger, or for the ignition to be turned on. This allows the system to be repeatedly triggered, disarmed and rearmed, while still allowing FACT to bypass a faulty zone.

When disarming the system, 5 chirps indicate FACT is activated. The LED will report the zone that has been bypassed. (See *Table of Zones* section of this guide.)

## Smart Power Up II

The Smart Power Up II feature ensures that when the security system is powered back up after power has been disconnected, the system will resume the same state it was in before power was lost. For example, if power is disconnected during a full trigger sequence, the system will still be in the full trigger sequence when power is reconnected to the unit. If power is disconnected while the unit is disarmed, it will still be disarmed when power is restored. This also applies to the VRS sequence. If the unit loses power at any time during the VRS sequence, it will automatically resume the VRS full trigger sequence when the unit is powered back up.

# Troubleshooting

*Starter kill doesn't work.*

- ▶ Is the correct starter wire being interrupted? If the car starts when the starter kill relay is completely disconnected, the wrong starter wire has been cut and interrupted.
- ▶ YELLOW wire is not connected to true ignition. It is connected to an accessory circuit.

*Shock sensor doesn't trigger the alarm.*

- ▶ Has the FACT system been triggered? If so, you will hear five chirps when disarming. To check this, turn the ignition key on and off to clear the FACT from memory, and then retest the shock sensor. For a detailed description of FACT, see Owner's Guide.

*Door input does not immediately trigger full alarm. Instead, I hear chirps for the first three seconds.*

- ▶ That's how the progressive two-stage door input works! This is the instant response feature of this system. Even if the door is closed immediately, the system provides an instant trigger by chirping, and the progressing to a constant siren.

*Closing the door triggers the system, but opening the door does not.*

- ▶ Have you correctly identified the type of door switch system? This happens often when the wrong door input has been used.

*System will not passively arm until it is remotely armed and then disarmed.*

- ▶ Are the door inputs connected? Is a blue wire connected to the door trigger wire in the vehicle? Either the green H1/5 or the violet H1/7 should be used instead.

*Door input does not respond with the progressive trigger, but with immediate full alarm.*

- ▶ What zone does the LED indicate? If the LED indicates that the impact sensor caused the trigger, the sensor may be detecting the door opening. Reducing the sensitivity or relocating the sensor can often solve this problem. If the LED indicates that the door caused the trigger, you may have programmed the progressive door trigger off. (See Feature 2-4 in the *Feature Descriptions* section of this guide.)

*The Valet button doesn't work.*

- ▶ Is it plugged into the correct socket? Check the System Features Learn Routine for the programmed Valet pulse count.

*Status LED doesn't work.*

- ▶ Make sure that it is plugged in. (See *Plug-In Harnesses* section of this guide.) Is the LED plugged into the correct socket?

# Wiring Quick Reference Guide

